



## Marina, St. Leonards-On-Sea TN38 0BP

Offers in excess of £220,000



A spacious TWO BEDROOM APARTMENT with UNBEATABLE SEA VIEWS situated in a prime seafront location with the beach on your doorstep and it's just a short stroll from the hub of St. Leonards On Sea where you'll find local independent shops, award winning eateries and galleries, along with a mainline railway station with connections through to London. Spanning the top floor of this attractive, PERIOD RESIDENCE, the accommodation here is arranged as a spacious open plan living and kitchen which measures an impressive 24'2 x 13'6 giving ample space for a full dining table. There are two double bedrooms, one of which is positioned at the front of the property benefitting from sea views and there is a large family bathroom which enjoys a FREESTANDING BATH, a DOUBLE WIDTH SHOWER and handy UTILITY CUPBOARD. Occupying a SOUGHT AFTER LOCATION this fantastic property would make the PERFECT SEASIDE RETREAT or FIRST TIME HOME and is not to be missed.

GROUND FLOOR  
983 sq.ft. (91.3 sq.m.) approx.

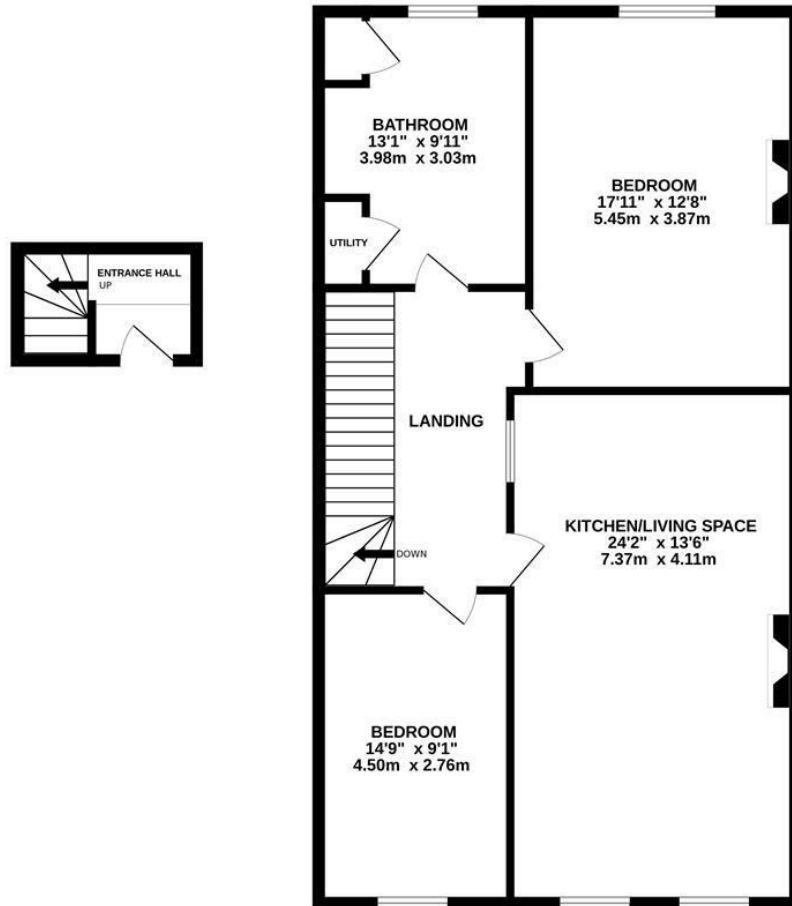

TOTAL FLOOR AREA: 983 sq.ft. (91.3 sq.m.) approx.

Whilst every attempt has been made to ensure the accuracy of the floorplan contained here, measurements of doors, windows, rooms and any other items are approximate and no responsibility is taken for any error, omission or mis-statement. This plan is for illustrative purposes only and should be used as such by any prospective purchaser. The services, systems and appliances shown have not been tested and no guarantee as to their operability or efficiency can be given.  
Made with Metropix ©2025

